

U-Kern U 15/6,7  
U core U 15/6.7

**Magn. Formkenngrößen/Satz**

**Eff. magn. parameters/set**

Formfaktor core factor	$C_1 =$	1,6 mm <sup>-1</sup>
Eff. magn. Weglänge eff. magn. path length	$l_e =$	48,0 mm
Eff. magn. Querschnitt eff. magn. cross section	$A_e =$	30,0 mm <sup>2</sup>
Eff. magn. Volumen eff. magn. volume	$V_e =$	1500 mm <sup>3</sup>
Gewicht weight	$G =$	9 g

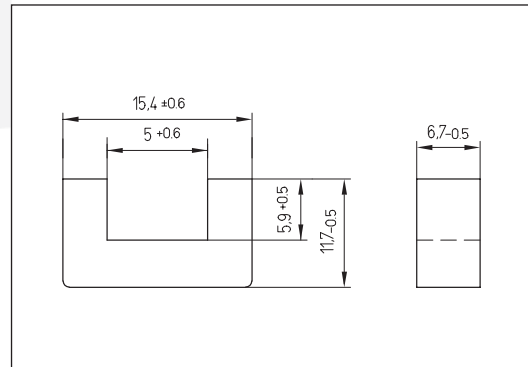

$A_L$ -Wert $A_L$ - value nH	Toleranz tolerance	Werkstoff material	Luftspalt airgap mm	$\mu_e$	Bestellnummer order number
1250	± 25%	K 2004	-	≈ 1600	325 150600 024
1300	± 25%	K 2006	-	≈ 1660	325 150600 026
2800	± 25%	K 6000	-	≈ 3580	325 150600 006

**Bei Anwendung in Leistungsübertragern**  
**For application in power transformers**

Werkstoff material	Messbedingungen test conditions	Verluste/Satz losses/set
K 2004	25kHz, 200mT, 100°C	≤ 0,27 W
K 2006	25kHz, 200mT, 100°C	≤ 0,17 W

All information given without liability. If you require further information about our products, do not hesitate to contact our representatives, or visit our homepage, [www.kaschke.de](http://www.kaschke.de).

**Kaschke Components GmbH**

Rudolf-Winkel-Straße 6 · 37079 Göttingen · Germany  
Fon +49 (0) 5 51-50 58-6 · Fax +49 (0) 5 51-65 75 6  
[kaschke.de](http://kaschke.de)