

| REVISIONS |                           |             |           |       |
|-----------|---------------------------|-------------|-----------|-------|
| P         | LTR                       | DESCRIPTION | DATE      | BY    |
| P3        | REVISED PER ECO-19-012325 |             | 08AUG2019 | SY HL |

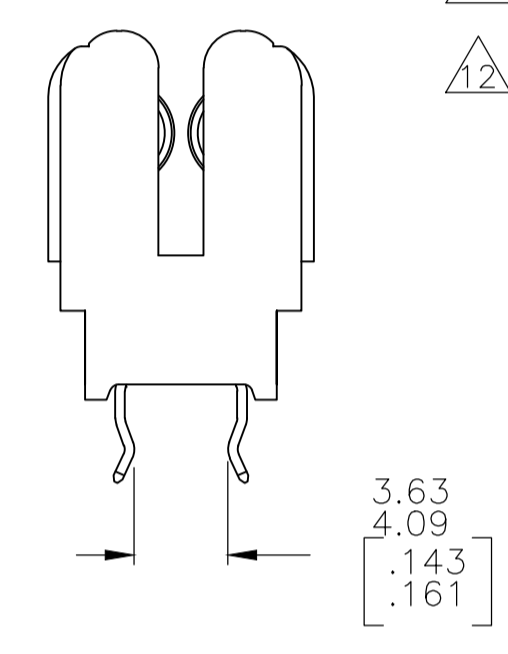

BOARD RETENTION FEATURE

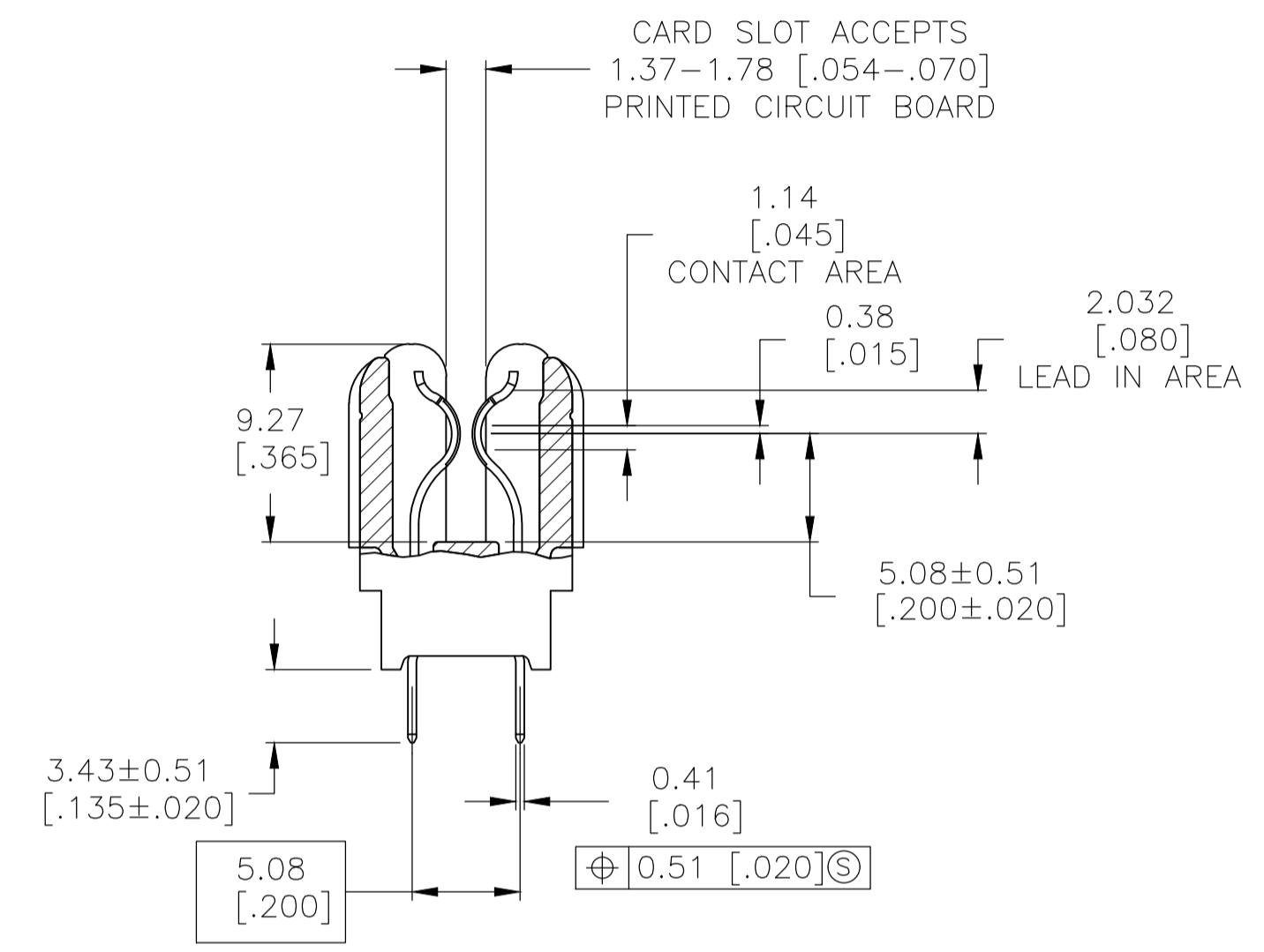
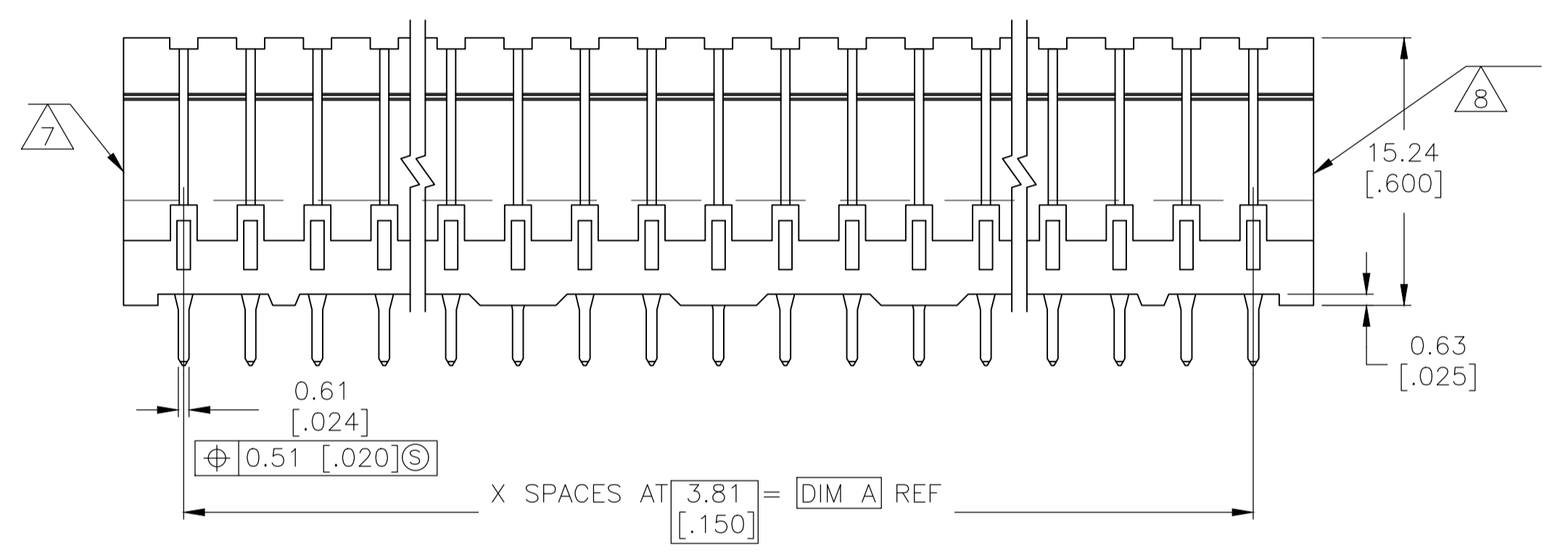
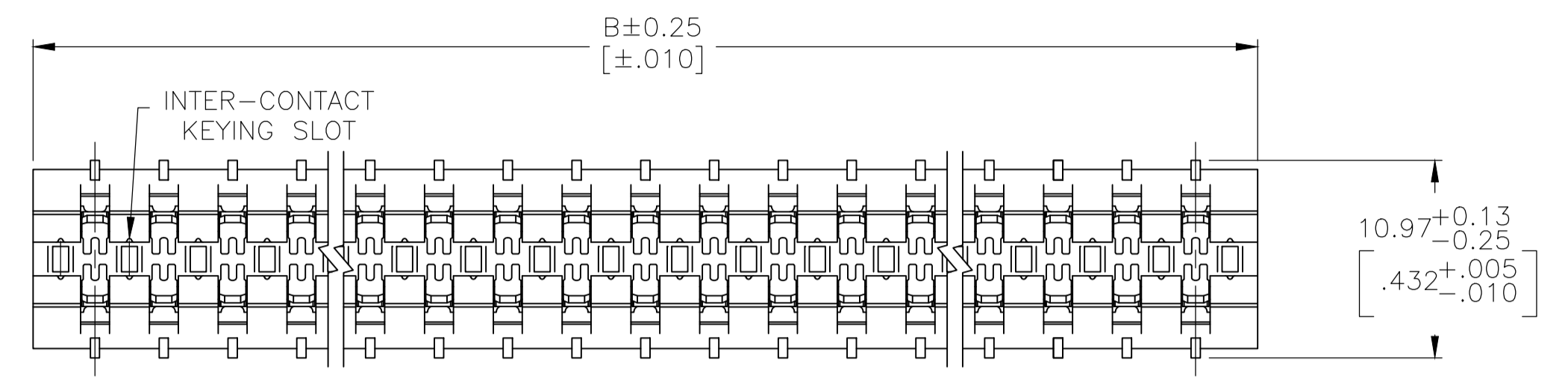
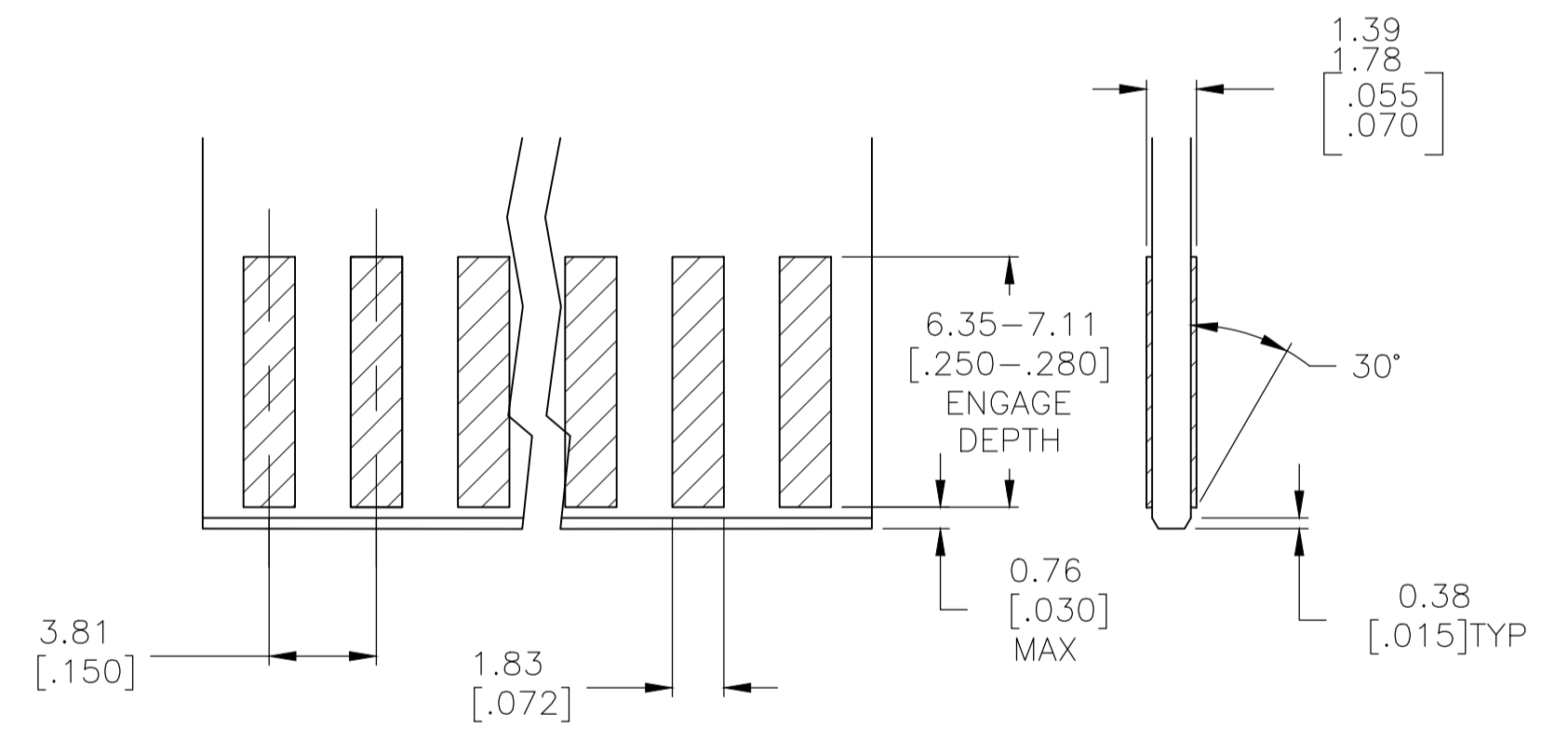

DAUGHTER CARD

- 1 HOUSING: GLASS FILLED POLYESTER; COLOR: BLACK.
- 2 CONTACT: PHOSPHOR BRONZE.
- 3 HARD NICKEL PLATE .0038 {0.00150} MIN. THICKNESS AND 425 MIN. KNOOP HARDNESS IN LEAD-IN AREA, .0013 [0.00050] MIN THICKNESS ALL OVER. NOTE: PLATING HARDNESS CAN NOT BE MEASURED ON THE
- 4 TIN-LEAD PLATE: 0.00254 [0.00100] MIN - SOLDER POSTS.
- 5 GOLD PLATE: 0.00076 [0.00030] MIN - CONTACT AREA.
- 6 NICKEL PLATE PER MIL-G-45204. GOLD PLATE PER QQ-N-290.
- 7 UL & CSA LOGOS MOLDED ON END.
- 8 THE WORD MEXICO MOLDED ON END.
- 9 RECOMMENDED PCB FINISHED HOLE DIA: 1.02 # 0.08 [0.40 #.003].
- 10 THE RETENTIVE FEATURE OF THIS CONNECTOR IS DESIGNED FOR FULL SEATING IN .062 .008 THICK CIRCUIT BOARDS. FOR APPLICATIONS IN BOARDS OF OTHER THICKNESSES CONTACT AMP INCORPORATED.
- 11 MATTE TIN PLATE: 0.00254 [0.00100] MIN - SOLDER POSTS.
- 12 OBSOLETE PARTS: OBSOLETE CIS STREAMLINING PER D.RENAUD/D.SINISI

| REV | DESCRIPTION              | DATE               | BY             | CHK            | APPV |            |    |             |
|-----|--------------------------|--------------------|----------------|----------------|------|------------|----|-------------|
| 12  | OBSOLETE                 | 7-10, 27-34, 53-56 | 121.16 [4.770] | 114.30 [4.500] | 30   | 31         | 11 | 8-650728-1  |
|     |                          | 7-10, 25-32, 47-50 | 109.73 [4.320] | 102.87 [4.050] | 27   | 28         | 11 | 7-650728-8  |
|     |                          | 7-10, 29-32        | 75.44 [2.970]  | 68.58 [2.700]  | 18   | 19         | 11 | 6-650728-9  |
|     |                          | 7-10, 15-18        | 48.77 [1.920]  | 41.91 [1.650]  | 11   | 12         | 11 | 6-650728-2  |
|     |                          | 7-10, 39-46, 75-78 | 163.06 [6.420] | 156.21 [6.150] | 41   | 42         |    | 4-650728-2  |
| 12  | OBSOLETE                 | 7-10, 27-34, 53-56 | 121.16 [4.770] | 114.30 [4.500] | 30   | 31         |    | 3-650728-1  |
|     |                          | 7-10, 25-32, 47-50 | 109.73 [4.320] | 102.87 [4.050] | 27   | 28         |    | 2-650728-8  |
|     |                          | 7-10, 29-32        | 75.44 [2.970]  | 68.58 [2.700]  | 18   | 19         |    | 1-650728-9  |
|     |                          | 7-10, 27-30        | 71.63 [2.820]  | 64.77 [2.550]  | 17   | 18         |    | 1-650728-8  |
|     |                          | 7-10, 17-20        | 52.07 [2.070]  | 45.72 [1.800]  | 12   | 13         |    | 1-650728-3  |
|     |                          | 7-10, 15-18        | 48.77 [1.920]  | 41.91 [1.650]  | 11   | 12         |    | 1-650728-2  |
|     | BOARD RETENTION LOCATION |                    | B              | A              | X    | NO OF POSN |    | PART NUMBER |

THIS DRAWING IS A CONTROLLED DOCUMENT. **STE** TE Connectivity

DIMENSIONS: mm [INCHES] TOLERANCES UNLESS OTHERWISE SPECIFIED:

|        |                |
|--------|----------------|
| 0 PLC  | ± -            |
| 1 PLC  | ± -            |
| 2 PLC  | ± 0.13 [0.005] |
| 3 PLC  | ± -            |
| 4 PLC  | ± -            |
| ANGLES | ± -            |

MATERIAL: HOUSING: △ CONTACT: △△△△△

APPROVED: R. SHIREY/UTA 11JULY91, J. DIORAZIO 08OCT92

PRODUCT SPEC: 108-9039

APPLICATION SPEC: -

WEIGHT: 0.000000

CUSTOMER DRAWING

SCALE: 4:1 SHEET 1 OF 1 REV P3